

## Ecrous de fonction FM EO2

pour tubes acier inoxydable

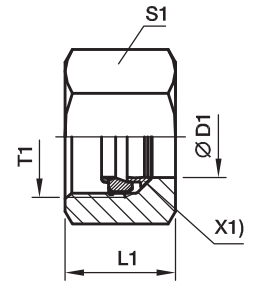

X1) Bague d'ancrage

Séries	D1 	T1	L1	S1	Référence								Poids gr./pièce
					FM...71 Acier inox		FM...NBR71 Acier inox		FM...SSA Acier zingué Sans Cr6 bague d'ancrage: Acier inox		FM...VITSSA Acier zingué Sans Cr6 bague de support: Acier inox		
					Joint FKM	PN (bar)	Joint NBR	PN (bar)	Joint NBR	PN (bar)	Joint FKM	PN (bar)	
LL	04	M8×1	11,0	10	—	—	—	—	<b>FM04LLASSA</b>	100	—	—	5
	06	M10×1	11,5	12	—	—	—	—	<b>FM06LLSSA</b>	100	—	—	6
L	06	M12×1,5	14,5	14	<b>FM06L71</b>	315	<b>FM06LNBR71</b>	315	<b>FM06LSSA</b>	315	<b>FM06LVITSSA</b>	315	12
	08	M14×1,5	14,5	17	<b>FM08L71</b>	315	<b>FM08LNBR71</b>	315	<b>FM08LSSA</b>	315	<b>FM08LVITSSA</b>	315	17
	10	M16×1,5	15,5	19	<b>FM10L71</b>	315	<b>FM10LNBR71</b>	315	<b>FM10LSSA</b>	315	<b>FM10LVITSSA</b>	315	22
	12	M18×1,5	15,5	22	<b>FM12L71</b>	315	<b>FM12LNBR71</b>	315	<b>FM12LSSA</b>	315	<b>FM12LVITSSA</b>	315	30
	15	M22×1,5	17,0	27	<b>FM15L71</b>	315	<b>FM15LNBR71</b>	315	<b>FM15LSSA</b>	315	<b>FM15LVITSSA</b>	315	48
	18	M26×1,5	18,0	32	<b>FM18L71</b>	315	<b>FM18LNBR71</b>	315	<b>FM18LSSA</b>	315	<b>FM18LVITSSA</b>	315	70
	22	M30×2	20,0	36	<b>FM22L71</b>	160	<b>FM22LNBR71</b>	160	<b>FM22LSSA</b>	160	<b>FM22LVITSSA</b>	160	94
	28	M36×2	21,0	41	<b>FM28L71</b>	160	<b>FM28LNBR71</b>	160	<b>FM28LSSA</b>	160	<b>FM28LVITSSA</b>	160	106
	35	M45×2	24,0	50	<b>FM35L71</b>	160	<b>FM35LNBR71</b>	160	<b>FM35LSSA</b>	160	<b>FM35LVITSSA</b>	160	160
	42	M52×2	24,0	60	<b>FM42L71</b>	160	<b>FM42LNBR71</b>	160	<b>FM42LSSA</b>	160	<b>FM42LVITSSA</b>	160	244
S	06	M14×1,5	16,5	17	<b>FM06S71</b>	630	<b>FM06SNBR71</b>	630	<b>FM06SSSA</b>	630	<b>FM06SVITSSA</b>	630	20
	08	M16×1,5	16,5	19	<b>FM08S71</b>	630	<b>FM08SNBR71</b>	630	<b>FM08SSSA</b>	630	<b>FM08SVITSSA</b>	630	23
	10	M18×1,5	17,5	22	<b>FM10S71</b>	630	<b>FM10SNBR71</b>	630	<b>FM10SSSA</b>	630	<b>FM10SVITSSA</b>	630	37
	12	M20×1,5	17,5	24	<b>FM12S71</b>	630	<b>FM12SNBR71</b>	630	<b>FM12SSSA</b>	630	<b>FM12SVITSSA</b>	630	39
	14	M22×1,5	20,5	27	<b>FM14S71</b>	630	<b>FM14SNBR71</b>	630	<b>FM14SSSA</b>	630	<b>FM14SVITSSA</b>	630	60
	16	M24×1,5	20,5	30	<b>FM16S71</b>	400	<b>FM16SNBR71</b>	400	<b>FM16SSSA</b>	400	<b>FM16SVITSSA</b>	400	72
	20	M30×2	24,0	36	<b>FM20S71</b>	400	<b>FM20SNBR71</b>	400	<b>FM20SSSA</b>	400	<b>FM20SVITSSA</b>	400	121
	25	M36×2	27,0	46	<b>FM25S71</b>	400	<b>FM25SNBR71</b>	400	<b>FM25SSSA</b>	400	<b>FM25SVITSSA</b>	400	221
	30	M42×2	29,0	50	<b>FM30S71</b>	400	<b>FM30SNBR71</b>	400	<b>FM30SSSA</b>	400	<b>FM30SVITSSA</b>	400	248
	38	M52×2	32,5	60	<b>FM38S71</b>	315	<b>FM38SNBR71</b>	315	<b>FM38SSSA</b>	315	<b>FM38SVITSSA</b>	315	367

PN (bar) = PN (MPa)  
10