

Une gamme complète d'accessoires pour vérins ISO/VDMA



Série C95



Série CP95



Série C85





Série C55



Accessoires de montage



Série C85

Fixations de montage pour vérin ISO C85

Diamètre	Equerre (1pc)			Equerre (2pcs)			Bride		
	Acier	Aluminium	Inox ⁽²⁾	Acier	Aluminium	Inox ⁽²⁾	Acier	Aluminium	Inox ⁽²⁾
8	C85L10A	—	C85L10A-IN(F)	C85L10B	—	—	C85F10	—	C85F10-IN(F)
10	C85L10A	—	C85L10A-IN(F)	C85L10B	—	—	C85F10	—	C85F10-IN(F)
12	C85L16A	—	C85L16A-IN(F)	C85L16B	—	—	C85F16	—	C85F16-IN(F)
16	C85L16A	—	C85L16A-IN(F)	C85L16B	—	—	C85F16	—	C85F16-IN(F)
20	C85L25A	—	C85L25A-IN(F)	C85L25B	—	—	C85F25	—	C85F25-IN(F)
25	C85L25A	—	C85L25A-IN(F)	C85L25B	—	—	C85F25	—	C85F25-IN(F)
									

Diamètre	Tourillon			Articulation		
	Acier	Aluminium	Inox ⁽²⁾	Acier	Aluminium	Inox ⁽²⁾
8	C85T10	—	—	C85C10	—	C85C10-IN(F)
10	C85T10	—	—	C85C10	—	C85C10-IN(F)
12	C85T16	—	—	C85C16	—	C85C16-IN(F)
16	C85T16	—	—	C85C16	—	C85C16-IN(F)
20	C85T25	—	—	C85C25	—	C85C25-IN(F)
25	C85T25	—	—	C85C25	—	C85C25-IN(F)
						

Accessoires d'extrémité de tige pour vérin ISO C85

Diamètre	Tenon de tige rotulé		Chape de tige		Accouplement de compensation	
	Acier	Inox ⁽¹⁾	Acier	Inox ⁽¹⁾	Acier	Inox ⁽²⁾
8	KJ4D	KI5-DNIRO	GKM4-8	—	JA10-4-070	JS10-4-070
10	KJ4D	KI5-DNIRO	GKM4-8	—	JA10-4-070	JS10-4-070
12	KJ6D	KI6-DNIRO	GKM6-12	GKM6-12-IN(F)	JA15-6-100	—
16	KJ6D	KI6-DNIRO	GKM6-12	GKM6-12-IN(F)	JA15-6-100	—
20	KJ8D	KI8DNRM8x125	GKM8-16	GKM8-16-IN(F)	JA20-8-125	JS20-8-125
25	KJ10D	KI10DNRBCTM10x125	GKM10-20	GKM10-20-IN(F)	JA30-10-125	JS32-10-125
						

(1) Inox AISI 303

(2) Inox AISI 304

Accessoires de montage

Séries CP95/C95

Fixations de montage pour vérins ISO CP95 et C95

Diamètre	Equerre MS1 (2pcs)			Bride AV MF1 & AR MF2			Tenon arrière MP4			Chape arrière MP2 ⁽³⁾			Chape arrière étroite ⁽³⁾		
	Acier	Aluminium	Inox ⁽²⁾	Acier	Aluminium	Inox ⁽²⁾	Acier	Aluminium	Inox ⁽²⁾	Acier	Aluminium	Inox ⁽²⁾	Acier	Aluminium	Inox ⁽²⁾
32	L5032	—	L5032-IN(F)	F5032	—	F5032-IN(F)	C5032	C5032(F)	C5032-IN(F)	D5032	D5032(F)	D5032-IN(F)	DS5032	DS5032(F)	DS5032-IN(F)
40	L5040	—	L5040-IN(F)	F5040	—	F5040-IN(F)	C5040	C5040(F)	C5040-IN(F)	D5040	D5040(F)	D5040-IN(F)	DS5040	DS5040(F)	DS5040-IN(F)
50	L5050	—	L5050-IN(F)	F5050	—	F5050-IN(F)	C5050	C5050(F)	C5050-IN(F)	D5050	D5050(F)	D5050-IN(F)	DS5050	DS5050(F)	DS5050-IN(F)
63	L5063	—	L5063-IN(F)	F5063	—	F5063-IN(F)	C5063	C5063(F)	C5063-IN(F)	D5063	D5063(F)	D5063-IN(F)	DS5063	DS5063(F)	DS5063-IN(F)
80	L5080	—	L5080-IN(F)	F5080	—	F5080-IN(F)	C5080	C5080(F)	C5080-IN(F)	D5080	D5080(F)	D5080-IN(F)	DS5080	DS5080(F)	DS5080-IN(F)
100	L5100	—	L5100-IN(F)	F5100	—	F5100-IN(F)	C5100	C5100(F)	C5100-IN(F)	D5100	D5100(F)	D5100-IN(F)	DS5100	DS5100(F)	DS5100-IN(F)
125	L5125	—	—	F5125	—	—	C5125	C5125(F)	—	D5125	D5125(F)	—	DS5125	DS5125(F)	—

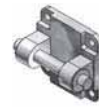

Diamètre	Tenon arrière rotulé			Tenon arrière d'équerre rotulé			Tenon arrière d'équerre			Axe & circlips de chape Ar MP2			Axe & circlips de chape Ar étroite		
	Acier	Aluminium	Inox ⁽²⁾	Acier	Aluminium	Inox ⁽²⁾	Acier	Aluminium	Inox ⁽²⁾	Acier	Aluminium	Inox ⁽²⁾	Acier	Aluminium	Inox ⁽²⁾
32	CS5032(F)	—	CS5032-IN(F)	ES5032(F)	—	ES5032-IN(F)	E5032	E5032(F)	E5032-IN(F)	—	—	IN07/32(F)	—	—	IN07/32(F)
40	CS5040(F)	—	CS5040-IN(F)	ES5040(F)	—	ES5040-IN(F)	E5040	E5040(F)	E5040-IN(F)	—	—	IN07/40(F)	—	—	IN07/40(F)
50	CS5050(F)	—	CS5050-IN(F)	ES5050(F)	—	ES5050-IN(F)	E5050	E5050(F)	E5050-IN(F)	—	—	IN07/50(F)	—	—	IN07/50(F)
63	CS5063(F)	—	CS5063-IN(F)	ES5063(F)	—	ES5063-IN(F)	E5063	E5063(F)	E5063-IN(F)	—	—	IN07/63(F)	—	—	IN07/63(F)
80	CS5080(F)	—	CS5080-IN(F)	ES5080(F)	—	ES5080-IN(F)	E5080	E5080(F)	E5080-IN(F)	—	—	IN07/80(F)	—	—	IN07/80(F)
100	CS5100(F)	—	CS5100-IN(F)	ES5100(F)	—	ES5100-IN(F)	E5100	E5100(F)	E5100-IN(F)	—	—	IN07/100(F)	—	—	IN07/100(F)
125	CS5125(F)	—	—	ES5125(F)	—	—	E5125(F)	—	—	—	—	—	—	—	—



Fixations de montage pour vérins ISO C95

Diamètre	Tourillon central MT4			Paliers pour tourillon			Paliers pour tourillon MT4		
	Acier	Aluminium	Inox ⁽²⁾	Acier	Aluminium	Inox	Acier	Aluminium	Inox
32	TE5032(F)	—	TE5032-IN(F)	C95-S03	—	—	MTB5032(F)	—	—
40	TE5040(F)	—	TE5040-IN(F)	C95-S04	—	—	MTB5040(F)	—	—
50	TE5050(F)	—	TE5050-IN(F)	C95-S04	—	—	MTB5040(F)	—	—
63	TE5063(F)	—	TE5063-IN(F)	C95-S06	—	—	MTB5063(F)	—	—
80	TE5080(F)	—	TE5080-IN(F)	C95-S06	—	—	MTB5063(F)	—	—
100	TE5100(F)	—	TE5100-IN(F)	C95-S10	—	—	MTB5100(F)	—	—
125	—	—	—	—	—	—	MTB5125(F)	—	—

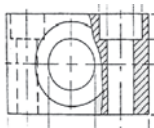
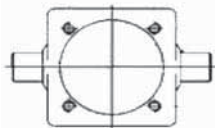

Accessoires d'extrémité de tige pour vérins ISO CP95 et C95

Diamètre	Tenon de tige rotulé		Chape de tige		Accouplement de compensation	
	Acier	Inox ⁽¹⁾	Acier	Inox ⁽¹⁾	Acier	Inox ⁽⁴⁾
32	KJ10D	KI10DNRBCTM10X125	GKM10-20	GKM10-20-IN(F)	JA30-10-125	JS32-10-125
40	KJ12D	KI12DNRBCM12X125	GKM12-24	GKM12-24-IN(F)	JA40-12-125	—
50	KJ16D	KI16DNRBM16X150	GKM16-32	GKM16-32-IN(F)	JA50-16-150	—
63	KJ16D	KI16DNRBM16X150	GKM16-32	GKM16-32-IN(F)	JA50-16-150	—
80	KJ20D	KI20DNRBM20X150	GKM20-40	GKM20-40-IN(F)	JAH50-20-150	—
100	KJ20D	KI20DNRBM20X150	GKM20-40	GKM20-40-IN(F)	JAH50-20-150	—
125	KJ27D	KI30DNRBM27X200	GKM27-54	—	—	—







(1) Inox AISI 303 (3) Pour la chape en inox, commander l'axe séparément.





(2) Inox AISI 316 (4) Inox AISI 304

Accessoires de montage



Série C55

Fixations de montage pour vérin compact ISO C55

Diamètre	Equerres	Bride AV MF1 & AR MF2				Tenon arrière MP4			Chape arrière MP2 ⁽³⁾			Chape arrière étroite ⁽³⁾		
	Acier	Acier	Aluminium	Inox ⁽²⁾	Acier	Aluminium	Inox ⁽²⁾	Acier	Aluminium	Inox ⁽²⁾	Acier	Aluminium	Inox ⁽²⁾	
20	C55-L020	C55-F020	—	—	—	C55-C020	—	—	—	—	—	—	—	
25	C55-L025	C55-F025	—	—	—	C55-C025	—	—	—	—	—	—	—	
32	C55-L032	F5032	—	F5050-IN(F)	C5032	C5032(F)	C5032-IN(F)	D5032	D5032(F)	D5032-IN(F)	DS5032	DS5032(F)	DS5032-IN(F)	
40	C55-L040	F5040	—	F5063-IN(F)	C5040	C5040(F)	C5040-IN(F)	D5040	D5040(F)	D5040-IN(F)	DS5040	DS5040(F)	DS5040-IN(F)	
50	C55-L050	F5050	—	F5080-IN(F)	C5050	C5050(F)	C5050-IN(F)	D5050	D5050(F)	D5050-IN(F)	DS5050	DS5050(F)	DS5050-IN(F)	
63	C55-L063	F5163	—	F5100-IN(F)	CR063	C5063(F)	C5063-IN(F)	D5063	D5063(F)	D5063-IN(F)	DS5063	DS5063(F)	DS5063-IN(F)	
														

Diamètre	Tenon arrière rotulé			Tenon arrière d'équerre rotulé			Tenon arrière d'équerre			Axe & circlips de chape Ar MP2			Axe & circlips de chape Ar étroite		
	Acier	Aluminium	Inox ⁽²⁾	Acier	Aluminium	Inox ⁽²⁾	Acier	Aluminium	Inox ⁽²⁾	Acier	Aluminium	Inox ⁽²⁾	Acier	Aluminium	Inox ⁽²⁾
20	—	—	—	—	—	—	—	—	—	—	—	—	—	—	—
25	—	—	—	—	—	—	—	—	—	—	—	—	—	—	—
32	CS5032(F)	—	CS5032-IN(F)	ES5032(F)	—	ES5032-IN(F)	E5032	E5032(F)	E5032-IN(F)	—	—	IN07/32(F)	—	—	IN12/32(F)
40	CS5040(F)	—	CS5040-IN(F)	ES5040(F)	—	ES5040-IN(F)	E5040	E5040(F)	E5040-IN(F)	—	—	IN07/40(F)	—	—	IN12/40(F)
50	CS5050(F)	—	CS5050-IN(F)	ES5050(F)	—	ES5050-IN(F)	E5050	E5050(F)	E5050-IN(F)	—	—	IN07/50(F)	—	—	IN12/50(F)
63	CS5063(F)	—	CS5063-IN(F)	ES5063(F)	—	ES5063-IN(F)	E5063	E5063(F)	E5063-IN(F)	—	—	IN07/63(F)	—	—	IN12/63(F)
															

Accessoires d'extrémité de tige pour vérin compact ISO C55

Diamètre	Tenon de tige rotulé		Chape de tige		Accouplement de compensation	
	Acier	Inox ⁽¹⁾	Acier	Inox ⁽¹⁾	Acier	Inox ⁽⁴⁾
20	KJ8D	KI8DNRM8x125	GKM8-16	GKM8-16-IN(F)	JA20-8-125	—
25	KJ8D	KI8DNRM8x125	GKM8-16	GKM8-16-IN(F)	JA20-8-125	—
32	KJ10D	KI10DNRBCTM10x125	GKM10-20	GKM10-20-IN(F)	JA30-10-125	—
40	KJ10D	KI10DNRBCTM10x125	GKM10-20	GKM10-20-IN(F)	JA30-10-125	—
50	KJ12D	KI12DNRBCTM12x125	GKM12-24	GKM12-24-IN(F)	JA40-12-125	JS25-10-125
63	KJ12D	KI12DNRBCTM12x125	GKM12-24	GKM12-24-IN(F)	JA40-12-125	JS25-10-125
						

(1) Inox AISI 303

(2) **Inox AISI 316**

(3) Pour la chape en inox, commander l'axe séparément.

(4) **Inox AISI 304**