



iwis wear gauges for roller chains and leaf chains

The optimum solution for chain wear elongation measurement

Patented iwis high-resistance stainless steel gauge sets indicate the percentage of chain elongation, thus providing additional support for maintenance programs with minimal effort.

Highlights:

- Allows precise measurement where conventional calipers cannot be used
- Suitable for measurement of BS & ANSI standard roller chains
- High-quality, robust, hard-wearing gauge set and case
- Gauge indicates whether the chain needs replacing and the percentage of stretch
- Suitable for use in food production applications
- Material: rustproof stainless steel
- Easy. Precise. Explicit.



Useful information

The new iwis wear gauges can measure chain wear elongation of up to **4%**. Depending on the application, it is advisable to replace a chain at the latest when elongation reaches max. **3%**. The **2.5%** elongation limit is marked separately to alert maintenance teams that chain replacement is imminent.

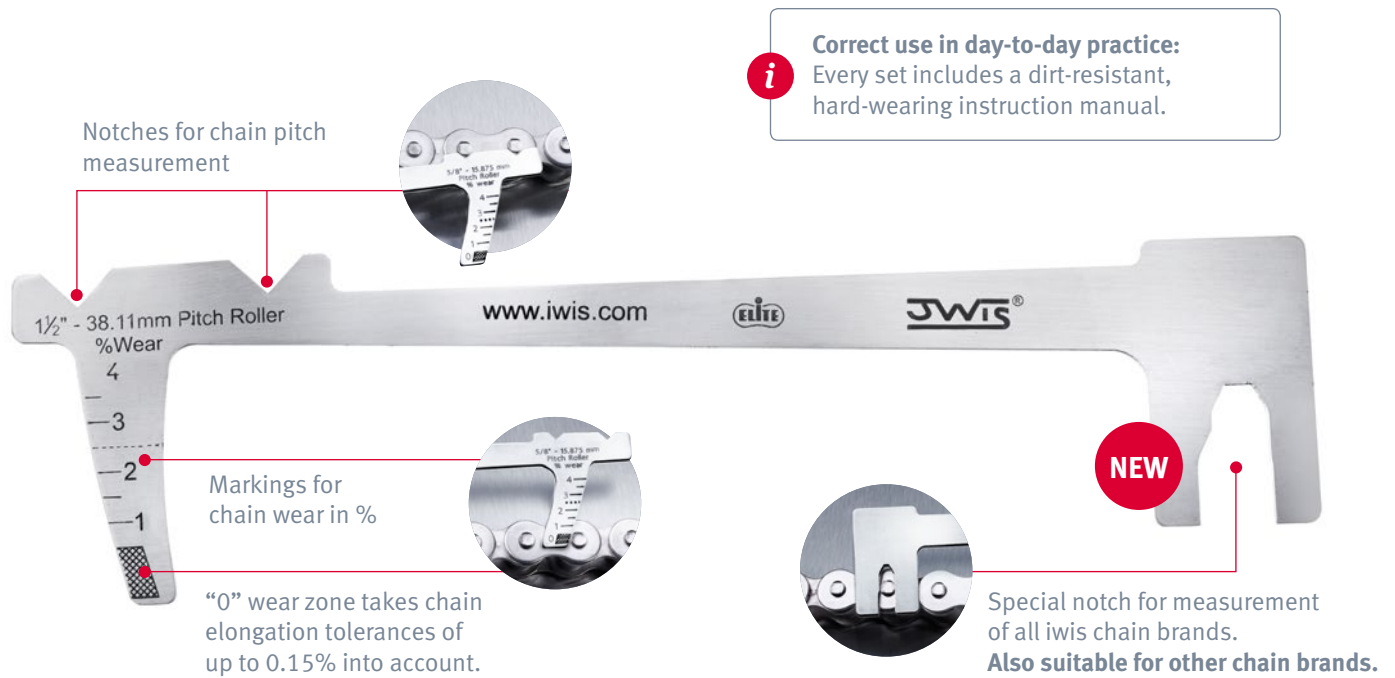

Available sizes:

Set	Material no.	3/8"	1/2"	5/8"	3/4"	1"	1 1/4"	1 1/2"	1 3/4"	2"
		06B/ANSI-35	08B/ANSI-40	10B/ANSI-50	12B/ANSI-60	16B/ANSI-80	20B/ANSI-100	24B/ANSI-120	28B/ANSI-140	32B/ANSI-160
1	40008015	•	•	•	•	•				
2	40008016						•	•	•	•

Gauge sets for measurement of leaf chains also available on request